

FRONT WHEEL/SUSPENSION/STEERING

Hold the steering stem and loosen the steering stem adjusting nut/upper inner race using the adjusting nut wrench.

TOOL:

Adjusting nut wrench

07SMA-GBC0100

ADJUSTING NUT WRENCH

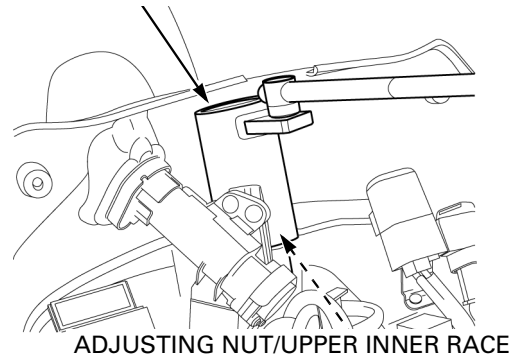

Hold the steering stem and remove the adjusting nut/upper inner race.

Remove the upper bearing.

UPPER BEARING

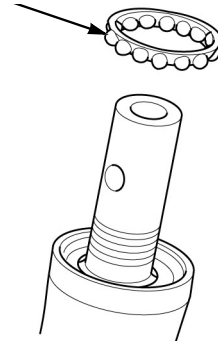

Remove the lower bearing and steering stem.

STEERING STEM

LOWER BEARING

