

INSTALLATION

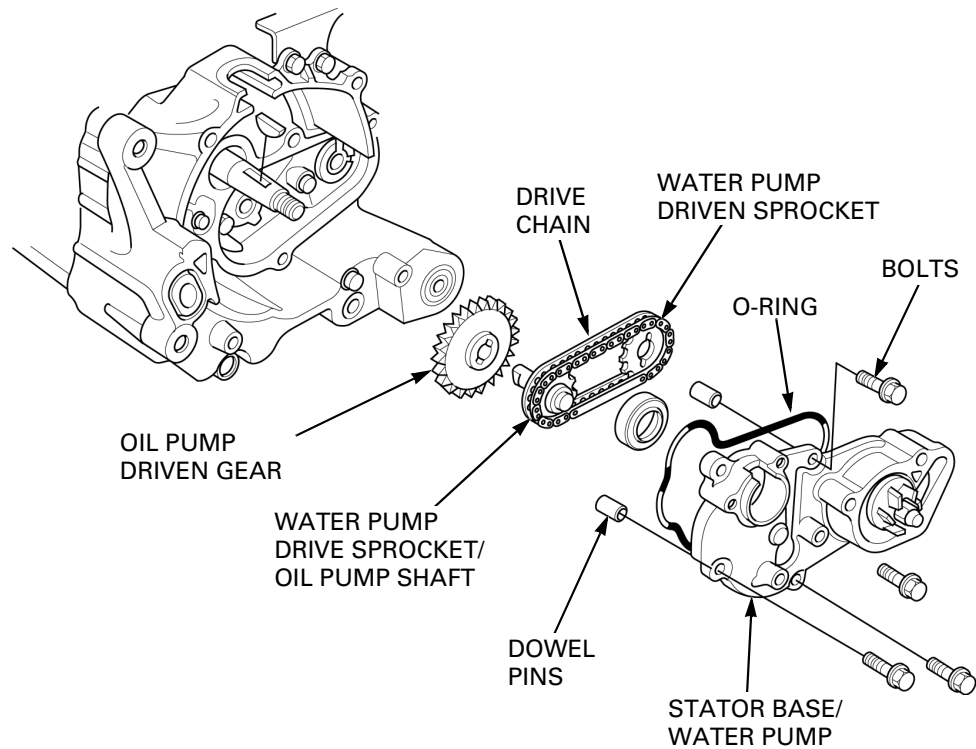

Install the new O-rings into the groove of the water pipe.

Install the water pipe into the stator base/water pump.

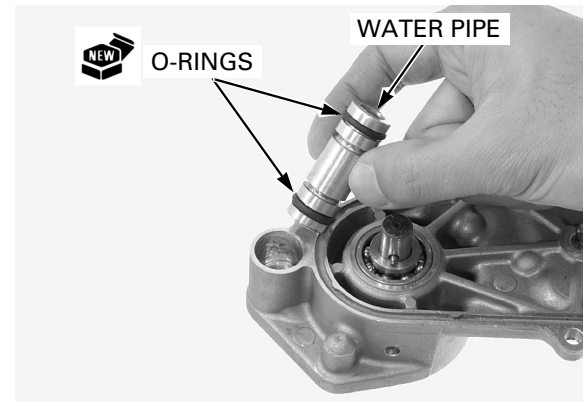

Apply engine oil to the oil pump shaft.  
Apply engine oil to the oil pump driven gear teeth.

Set the oil pump driven gear to the drive gear of the crankshaft as shown.

Install the water pump drive sprocket/oil pump shaft by aligning the oil pump shaft cut-out with the oil pump cut-out, and the pin groove of the oil pump driven gear with the pin of the oil pump shaft.

