

Check for continuity between the insulated brush and cable terminal.
There should be continuity.

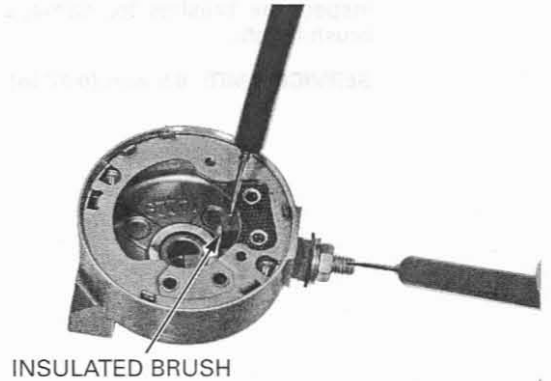

Check for continuity between the cable terminal and the rear cover.
There should be no continuity.

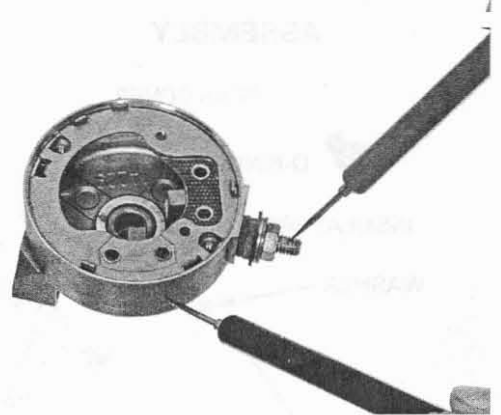

Record the location and number of insulators.

Remove the following:

- Nut
- Washer
- Insulators
- O-ring
- Brush holder assembly

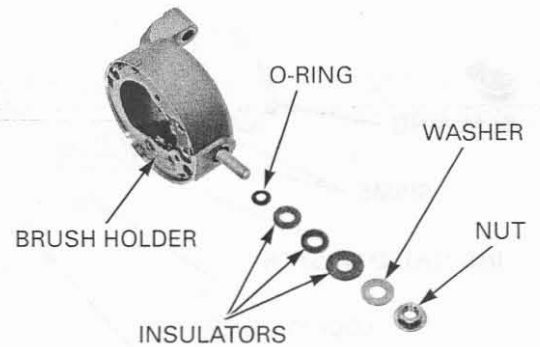

Remove the brush springs and brushes from the brush holder.

