

Check the caliper pistons for scratches, scoring or other damage.  
 Measure the caliper piston O.D.

**SERVICE LIMITS:**

- Piston A: 31.957 mm (1.2581 in)
- Piston B: 30.157 mm (1.1873 in)

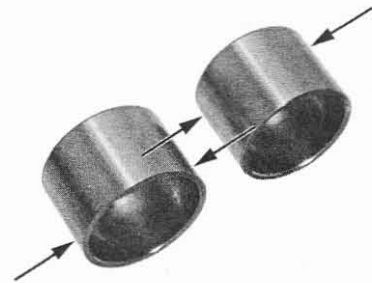

**ASSEMBLY**

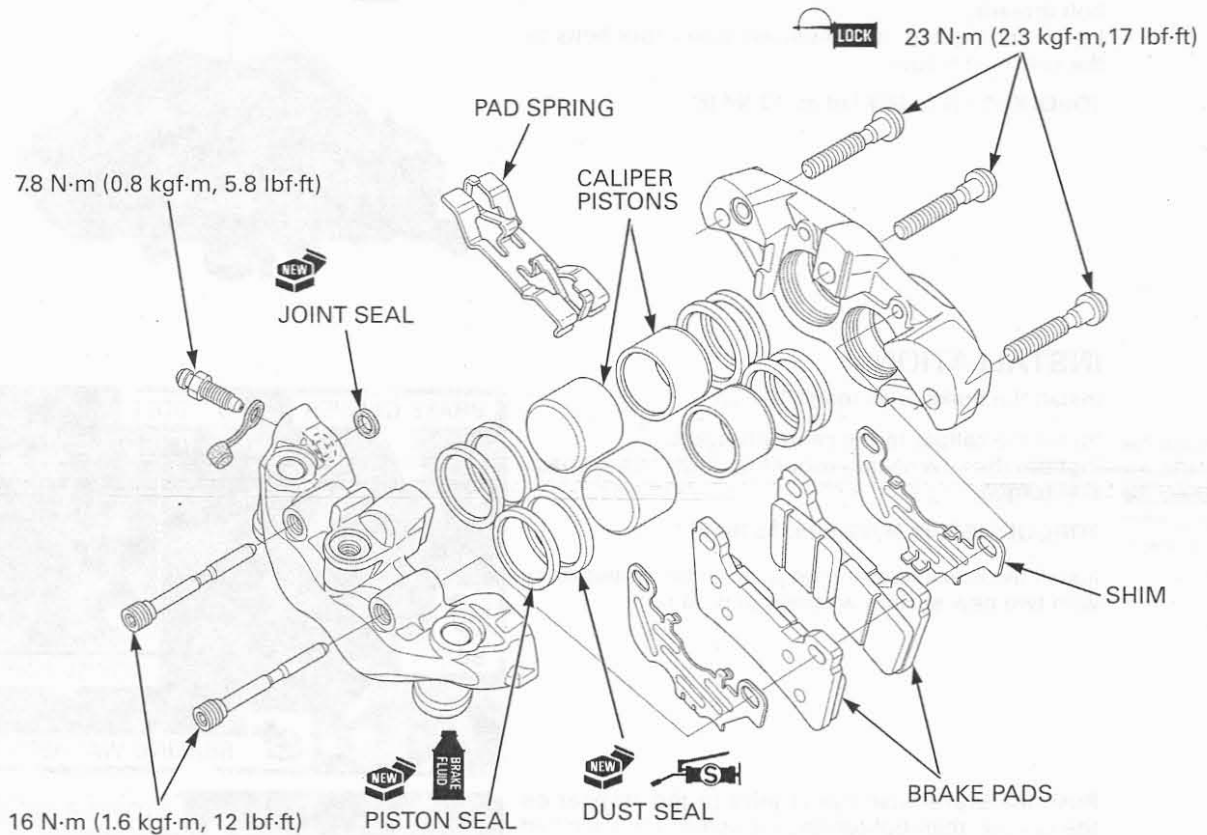

Coat new piston seals with clean brake fluid.  
 Coat new dust seals with silicone grease.  
 Install the piston and dust seals into the grooves of the caliper body.  
 Coat the caliper pistons with clean brake fluid and install them into the caliper cylinder with their open ends toward the pad.

