

ASSEMBLY

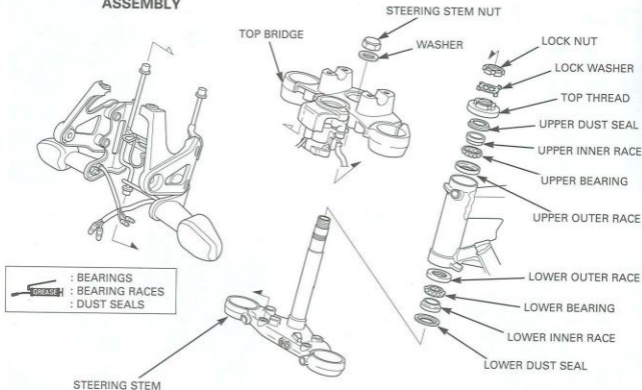

Apply grease to the new dust seal lips and install it over the steering stem.
Install a new lower bearing inner race using a special tool and a hydraulic press.

TOOL:

Steering stem driver

07946-MB00000

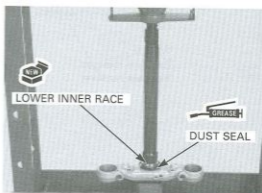

Remove the lower bearing outer race using the special tools.

TOOLS:

Driver handle

07749-0010000

Attachment 42x47

07749-0010300

Remove the upper bearing outer race using the special tools.

TOOLS:

Driver handle

07749-0010000

Attachment 42x47

07749-0010300

