

Oil Pump Disassembly/Assembly

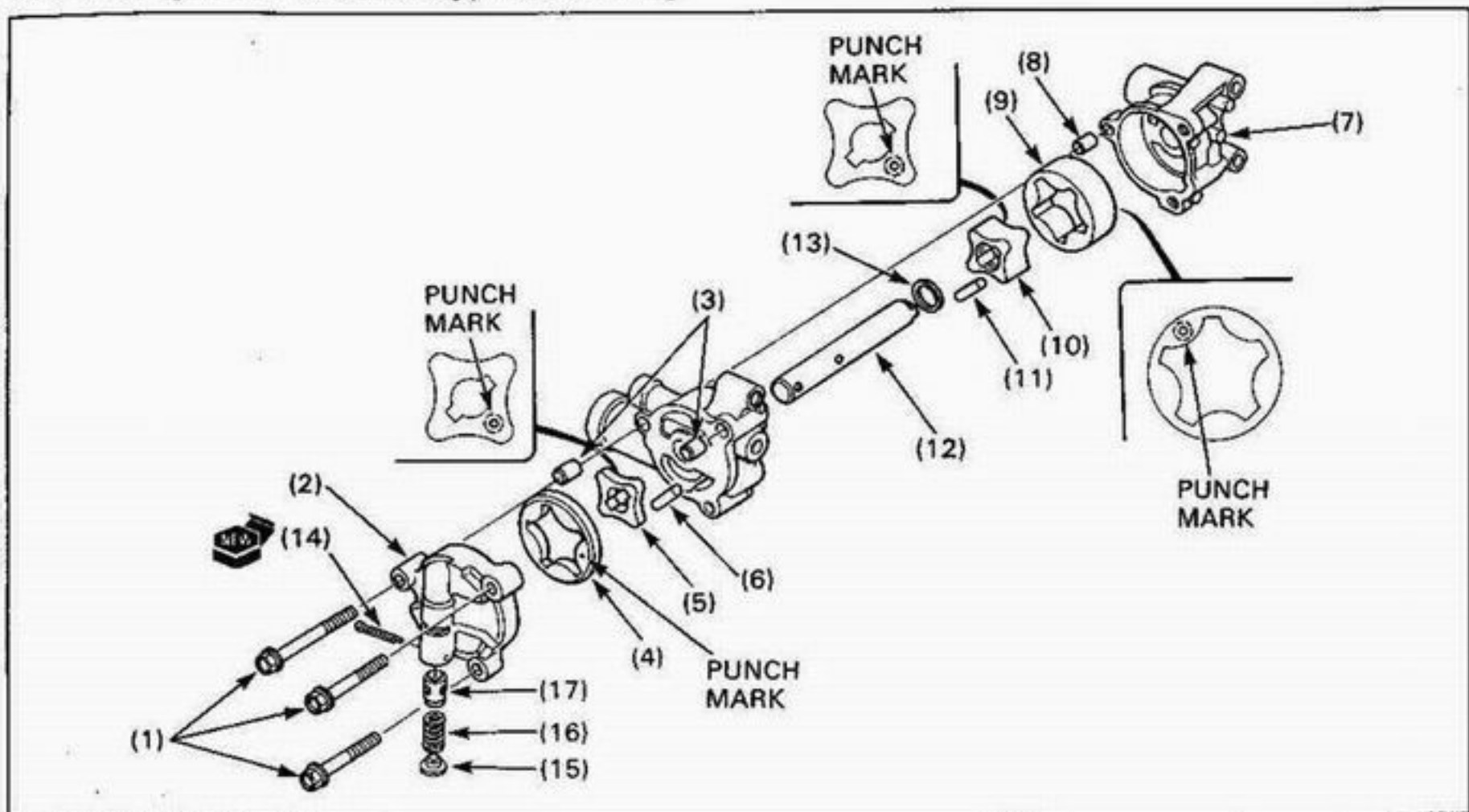

NOTE

- If any portion of the oil pump is worn beyond the specified service limit, replace the oil pump as an assembly.
- Before assembling them, clean all disassembled parts thoroughly with clean engine oil.
- Refer to section 4 of the Common Service Manual for inspection information.
- Refer to page 1-6 for specifications.

Requisite Service

- Oil pump removal/installation (page 4-3)

Procedure	Q'ty	Remarks
Disassembly Order		Assembly is in the reverse order of disassembly.
(1) Oil pump cover attaching bolt	3	
(2) Oil pump cover	1	
(3) Dowel pin	2	
(4) Cooler pump outer rotor	1	Install with its punch mark facing the pump cover.
(5) Cooler pump inner rotor	1	• Install aligning the cut out with the drive pin. • Install with its punch mark facing the pump body.
(6) Drive pin	1	
(7) Feed pump cover	1	
(8) Dowel pin	1	
(9) Feed pump outer rotor	1	Install with its punch mark facing the pump body.
(10) Feed pump inner rotor	1	• Install aligning the cut out with the drive pin. • Install with its punch mark facing the pump body.
(11) Drive pin	1	
(12) Pump shaft	1	
(13) Washer	1	
(14) Cotter pin	1	
(15) Spring seat	1	
(16) Spring	1	
(17) Relief valve	1	