

INSTALLATION

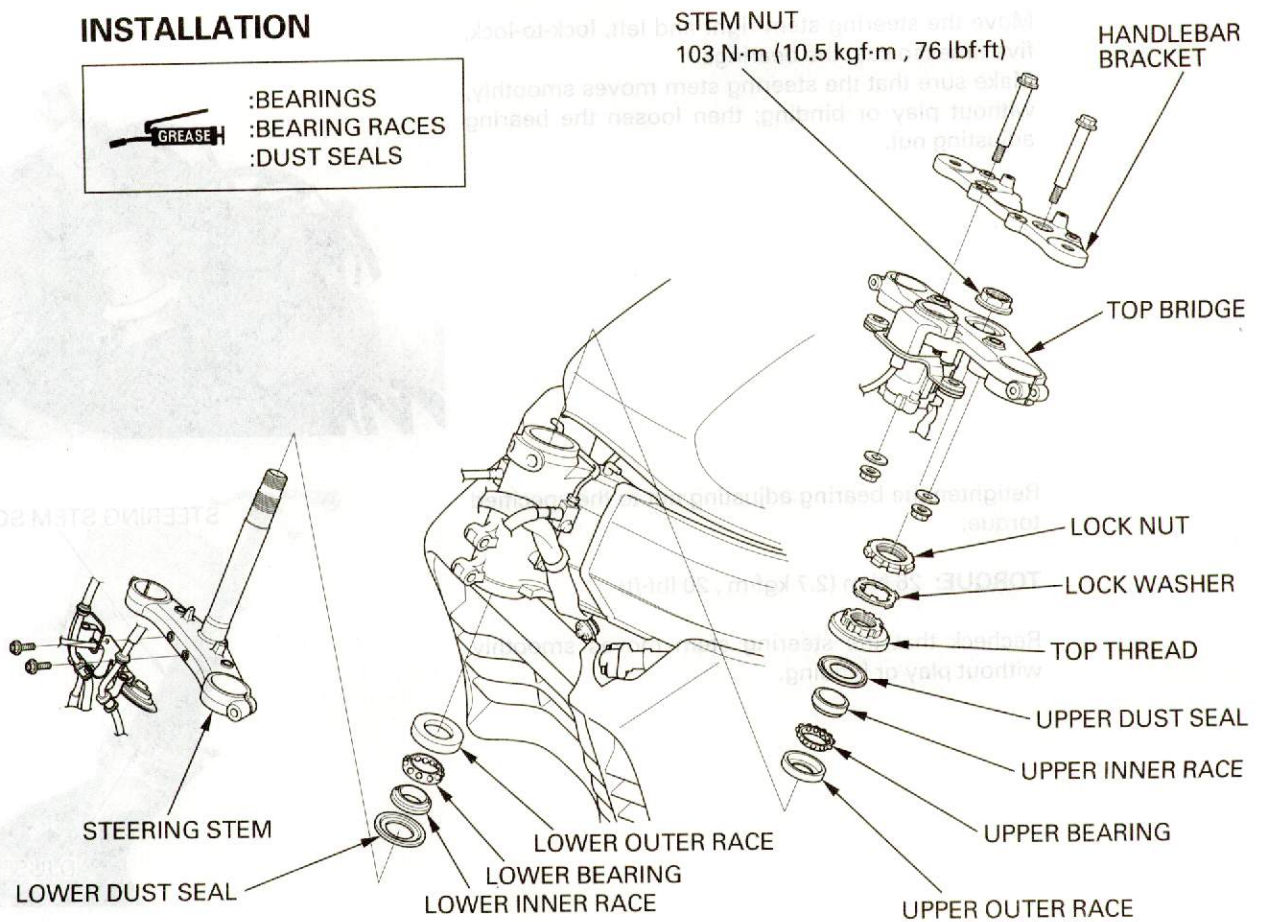

Apply grease to upper and lower bearings and bearing races.

Install the lower bearing onto the steering stem. Insert the steering stem into the steering head pipe.

Install upper bearing, inner race and dust seal.

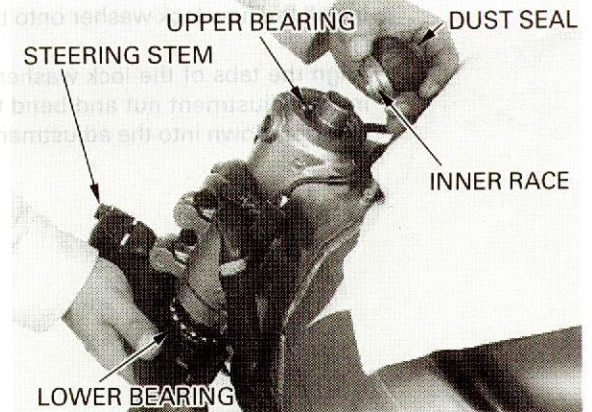

Apply oil to the bearing adjustment nut threads. Install and tighten the stem bearing adjusting nut to the initial torque.

TOOL:
Steering stem socket 07916-3710101

TORQUE: 26 N·m (2.7 kgf·m, 20 lbf·ft)

